



INVITATION

10TH INTERNATIONAL MARINE DESIGN CONFERENCE

26 – 29 May 2009, Trondheim, Norway

The aim of the International Marine Design Conference (IMDC) is to promote all aspects of marine design as an engineering discipline. The 10th Conference, organized by the Norwegian University of Science and Technology (NTNU), will support and further this aim through a strong technical program with contributions from both industry and academia around the world. The focus will be on key design challenges and opportunities in today's rapidly changing maritime marketplace, with special emphasis on sustainable design of vessels and fleet.

REGISTRATION

Please register at the conference website, www.imdc2009.com. Registration on site in May will not be possible. Speakers can register through Speaker Zone.

Early reg. fee (until March 25 2009):	€ 600
Late reg. fee (after March 25 2009):	€ 700
Student fee:	€ 200
Accompanying person fee:	€ 100

The fee includes a visit to the Nidaros Cathedral, Reception at the Arch Bishops Palace, Reception at MARINTEK and Conference Dinner. The dinner will take place at Britannia Hotel on May 28. Accompanying person fee covers dinners and receptions arranged by the IMDC2009 conference.

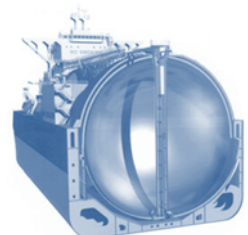
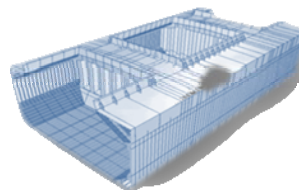

IMDC PROGRAMME

Time	Tuesday	Wednesday
0800-0900	Registration	Registration
0900-0930	Coffee	SoA paper Wednesday Design Methods and Tools
0930-1000		W-1.1 Design Methodology - II
1000-1030	Welcome by Rector and International committee	W-2.1 Novel and Improved Design - II
1030-1100	Local committee	W-3.1 Hydrodynamic Design and Hull Design - II
1100-1130	Keynotes First Session (2x45min)	Coffee break
1130-1200	The FPSO story – from Petrojar1 to Floating LNG, Dr.ing Kaare Moursund Gisvold	W-1.2 Design Methodology - III
1200-1230	Seeing what's next in design solutions: Developing the capability to build a disruptive commercial growth engine, Dr. Tore Ulstein	W-2.2 Novel and Improved Design - III
1230-1330	LUNCH	W-3.2 Hydrodynamic Design and Hull Design - III
1330-1400	Keynotes Second Session (3x30 min)	LUNCH
1400-1430	Cruise Ships – Success factors for the design, Kai Levander (STX Finland Cruise Oy)	W-1.3 Knowledge-Based Design Systems - I
1430-1500	Developments in Marine Design Methodology: Roots, Results and Future Trends, Horst Nowacki (TU Berlin)	W-2.3 Design For Safety - I
1500-1530	Coffee break	W-3.3 Hydrodynamic Design and Hull Design - IV
1530-1600	Tu-1 Design Methodology - I	Coffee break
1600-1630	Tu-2 Novel and Improved Design - I	W-1.4 Knowledge-Based Design Systems - II
1630-1700	Tu-3 Hydrodynamic Design and Hull Design - I	W-2.4 Design For Safety - II
Evening	Reception Erkebispegården and Concert Nidarosdomen	W-3.4 Ship Propulsion and Machinery Systems Design - I
		Reception MARINTEK

Time	Thursday	Friday
0800-0900	Registration	Registration
0900-0930	SoA paper Thursday Developments in Specific Design Aspects: Safety, economy, production, operation, arctic, comfort (Design for X)	SoA paper Friday Vessel Design Trends
0930-1000	T-1.1 Knowledge-Based Design Systems - III	F-1.1 Design Methodology - IV
1000-1030	T-1.1a Design Optimization - I	F-1.1a Sustainable Design - III
1030-1100	T-2.1 Ship Classification	F-2.1 Offshore Systems Design - I
1100-1130	T-2.2 Fleet Design and Maritime Logistics - I	F-3.1 Structural Design - III
1130-1200	T-3.1 Ship Propulsion and Machinery Systems Design - II	
1200-1230	T-3.1a Novel and Improved Design - IV	
1230-1330	LUNCH	LUNCH
1330-1400	T-1.2 Design Optimization - II	F-1.2 Sustainable Design - IV
1400-1430	T-2.3 Fleet Design and Maritime Logistics - II	F-2.2 Offshore Systems Design - II
1430-1500	T-3.2 Computer Applications In Design	F-3.2 Structural Design - IV
1500-1530	T-1.3 Sustainable Design - I	
1530-1600	T-2.4 Marine Design Education	
1600-1630	T-3.3 Structural Design - I	
1630-1700	T-3.4 Structural Design - II	
Evening	Conference dinner	

Friday 29 May and spouses program:

After lunch 29 May it is possible to attend suggested excursions. More information about excursions and spouses program will be put on the conference website.



Early registration deadline	25 March 2009
IMDC 2009	26-29 May 2009



IMDC INTERNATIONAL COMMITTEE

Professor Apostolos Papanikolaou
[Chairman]
National Technical University of Athens,
Greece

Aarie Aalbers, Professor Ir.
ASD Ship Design B.V. & Technical University
Delft, The Netherlands

David Andrews, Professor
University College London, UK

Rameswar Bhattacharyya, Professor
US Naval Academy, USA

Richard Birmingham, Professor
Newcastle University, UK

Yoshiyuki Inoue, Professor
Yokohama National University, Japan

Stein Ove Erikstad, Professor
Norwegian University of Science and
Technology, Norway

Oi-Hyun Kim, Dr.
Hyundai Heavy Industries - R&D Division,
Korea

Stefan Krüger, Professor
Technical University of Hamburg, Germany

Thomas Lamb, Emeritus Research Scientist
University of Michigan, USA

Kai Levander, SVP Aker Yards, Finland &
Adjunct Professor NTNU

Pratyush Sen, Professor
University of Newcastle, UK

Hiroyuki Yamato, Professor
University of Tokyo, Japan



PREVIOUS CONFERENCES

The locations of previous IMDC conferences have been:

1982	London, UK
1985	Lyngby, Denmark
1988	Pittsburgh, USA
1991	Kobe, Japan
1994	Delft, The Netherlands
1997	Newcastle, UK
2000	Kyongju, Korea
2003	Athens, Greece
2006	Ann Arbor, MI, USA



IMDC 2009 will be located in Trondheim, Norway, 500 km north of the capital Oslo and 560 km south of the Arctic Circle, but still easily accessible from major European airports.

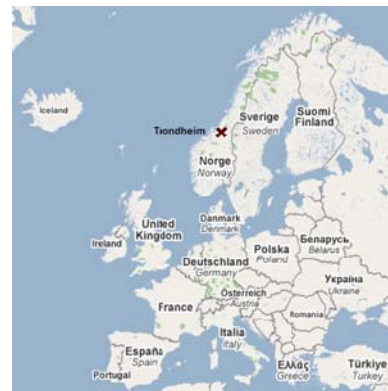

Trondheim was founded by the Viking king Olav Tryggvason in year 997 AD. The city was the country's first capital for two hundred years, a prospering centre for trade, shipping and culture. Today, Trondheim is the third largest city in Norway with 165.000 inhabitants, and is a major centre for high technology research, education and industry.



The wharves by the Nidelva River

The conference venue is at the University Campus Gløshaugen. A preliminary program and information about hotel reservations, recommended transportation etc is available at the conference website, www.imdc2009.com.



The old main building at NTNU, Campus Gløshaugen

The conference hotel is Britannia Hotel (www.britannia.no), Trondheim's most reput-able hotel with long traditions. It is situated in the middle of the city Centre, within walking distance of all restaurants and sights. The five star hotel can offer four restaurants to choose between in addition to a piano bar and cocktail bar, and will complete a new Spa Centre in 2008. The airport shuttle bus stops right outside the hotel.



CONFERENCE SECRETARIAT

NTNU Videre

Pav. A, Dragvoll

7491 Trondheim, Norway

Phone +47 7359 6643, Fax +47 7359 5150

Email: post@imdc2009.com

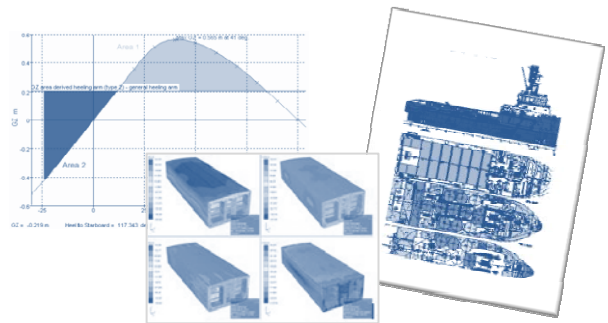

SPONSORS

